

INSM-100

Single Phase Smart Energy Meter with Disconnect and Reconnect



5-30A • 10-60A •

Features

- WAN – HAN upgradable
- Programmable TOU/TOD
- Multi-vendor – MDMS Capable
- Anti-Tamper and Tamper alerts by Instant Push
- End to end DLMS complaint complies IS 16444/IS 15959 Part II
- Multi-vendor Inter operable Communication with self-integrable capability
- Smart AMI with Programmable Post/Pre-payment and Net metering Modes
- Real-time Interoperable for Technology SWAP (GPRS-RF-PLC-IoT-WIFI-BLE)
- UC1 load switch with Configurable Demand and Peak load • Multi-vendor – MDMS Capable

Key Features

Powered by:
smarte

AMI

AMI READY



DISCONNECT
RECONNECT

LCD

DISPLAY



TECHNOLOGY
INTEROPERABLE

P-PAY

PREPAYMENT



TAMPER PROOF



PLUGGABLE
WAN



OTA
READY

PRODUCT INFORMATION

A State of the art smart[®] Powered AMI Smart meter with remote disconnect/reconnect, Demand management, real-time configurability for all key features with real-time pluggable WAN communication module. Comes in Handy with ready to go AMI in GPRS 2G/3G/IoT/LTE/PLC/RF communication modules. An indigenous designed global technology from India which can perform as Post payment, Prepayment and Net meter for whichever the mode its configured at site. The real-time pluggable options gives a complete flexibility for the user to use any convenient and economic technology for communication in the region. It supports multi-vendor communication and multi-technology swap in real-time. The advanced Inesh Smart Energy meter is designed to Utility standards complying IEC and IS standards can be used in smart homes, Smart office, Smart cities and smart villages for monitoring and controlling the energy efficiently. This is a best for Smart prepayment system for Smart gated homes and Smart commercial buildings where you get a complete control on payment and usage. Inesh supports the end to end solution in Smart metering and Smart billing.

SPECIFICATION

Measurement

- Class 1.0 Accuracy
- Compliance with IS 16444
- Four Quadrant measurement
- One Phase 2Wire 60A/90/120A Load switch
- Active and Apparent measurements both in import and export
- 0.000001kWh Resolution measurement
- Load survey and Day survey as per standards
- Neutral and Phase measurements
- Programmable Block Window and Sliding Window MD Calculation methods
- Programmable MD integration period and Reset dates
- Active, apparent, Import and Export MD registers

ELECTRICAL

Voltage and Power Supply

- Voltage - 240V AC, Frequency - 50Hz (Standard)
- Power supply surge - 440V
- Burden < 10VA (as per IS 16444)
- Power consumption = 5Watt(As per Standard)

Current

- Current ranges 5-30A /10-40A/10-60A /10-100A
- Overcurrent: 30 times I_{max} for 0.5 cycles
- Burden < 0.5VA
- Operating Temperature 27°C
- UC1 Load switch ranges 60A/90A/120A

Measured Energy Values

- Import/Export/Net Wh and VAh
- Absolute Wh and VAh

System Integration Support

- Interoperable DLMS compliance
- Self-Integrable with IS 16444 compliant MDMS
- Self-Integrable with multi-vendor Coms
- Programmable Alarms and instant push

Environmental

- Operating temperature range: -25°C to 60°C
- Limit range: -40°C to 70°C
- Storage range: -40°C to 80°C
- Relative humidity: Up to 75% mean, 95% non-condensing for 30 days
- Ingress protection: IP51
- Sealing: break-open sealing provision as per Standards
- Material: Engineering plastic/PC/Brass terminals

Time Clock and Calender

- Inbuilt RTC
- Accuracy (internal) as per standard, within 15 seconds per month
- Backup time of 10 years without power (lithium battery)
- Supports Daylight Saving Time

Time of Use

- Programmable TOD
- 4 TOD Timings

Security

- Multi-level security (user name and password including encrypted log-in)
- Up to seven independent security levels
- Up to six individual users
- AES128 bit encryption

Tamper Detection and Alarms

- Provision for sealing with conventional wire or plastic seals
- Bypassing current and reverse current
- Advanced tamper detection and logging
- Pre-programmed alarms for meter self-check
- Alarms trigger, enunciators, relay outputs or communications event
- Alarm Trigger Push – First breath and instant alarm push
- Alarms are stored in event logs
- Neutral missing Tamper
- Self-diagnostic feature
- Up to 200 Events storage

Communication

- DLMS inbuilt Client and Server mode
- IS 15959 Part II compliance, 6LoWPAN, G3/PRIME
- Optical, AMI and serial ports
- Pluggable and Technology interoperable WAN port
- Optional RS-232 with modem power supply (2G/3G supported)
- Optional RS-485 multi-drop (two or four wire RJ45 or two wire Screw terminal)
- UDP/IP/PPP/GPRS capable
- Narrow Band PLC capable
- License Free RF capable (865-867, 409, 433 Mhz)
- ZIGBEE/WIFI/BLE capable
- First Breath and Last GASP compliance
- Supports Push and Pull

Battery Options

- Internal Battery for Display and back up
- Separate Battery for RTC

Net Metering

- Inbuilt Net metering Mode
- Real-time Net metering Swap
- Configuration OTA remotely.
- Import, Export and Net Energy measurement

Meter Variants

- 1Phase 2W 5-30A
- 1Phase 2W 10-40A
- 1Phase 2W 10-60A
- 1Phase 2W 10-100A

Communication Variants

- Pluggable GPRS 2G/3G
- Pluggable IoT
- Pluggable RF (865-867, 409, 433MHz)
- Pluggable Narrowband PLC (G3/PRIME)
- Pluggable WIFI/BLE
- Optional RS232/RS485 Serial port COM
- Ethernet interface (Optional)

Load/day survey/Profile

- AMI Ready – Instant push and pull
- Inbuilt storage as per standard – expandable at factory
- Intervals programmable from 1 to 60 minutes
- Two independent surveys
- Energy, instantaneous readings as channel sources
- Ability to store average/minimum/maximum values for interval duration

Prepayment

- Inbuilt Prepayment mode
- Real-time prepayment and post payment selection.
- GPRS based Recharge capable
- Configuration of Mode over OTA
- Energy (kWh) and Value (Currency) based prepayment
- Programmable tariff plan

Physical Dimension

- Dimensions LDH – 180mm(L) x 115mm(D) x 70mm(H)
- Weight – 970 Grams

LCD Display

- LCD segment display
- Real-time Programmable display parameters
- Auto, Push and INFO Mode
- Feature icons for special conditions
- Communication indication
- Display digit size: 4.5mm (W): 10mm (H)
- Definable enunciators
- Display available even without mains power

OUTLINE DIAGRAM:

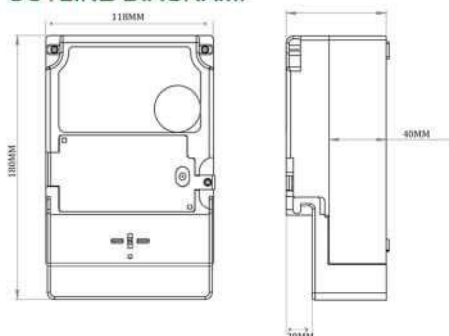

CONNECTION DIAGRAM:

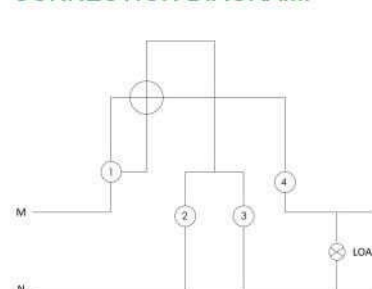

INESH SMART ENERGY (P) LTD .
183, Arcot Road, Valasarawakkam,
Chennai - 600 087.
Ph.No: 044-42623555



INESH SMART ENERGY (P) LTD
(North division)
Samaspur Road, Pandav Nagar, Delhi 11091.
email: salesdelhi@ineshenergy.com
Phone: +91 9821 994 994